WOO AUDIO WTP-1 AND WDS-1

Top-Loading CD Transport
&
24-Bit/192kHz Digital to Analog Converter



OWNER'S MANUAL

Please review this manual before operating your WOO AUDIO™ product.

Important Safety Information



CAUTION: These amplifiers are shipped without the vacuum tubes installed. It is necessary to install the tubes first. It is essential that the tubes are installed correctly or *serious damage that is not covered by the warranty will result.*



Turn off immediately in the event of malfunction
Should you notice smoke or an unusual smell coming from the equipments, turn it off immediately. Continued operation could result in injury.



Do not disassemble
High voltage circuit. Touching the product's internal parts could result in injury. In the event of malfunction, the product should be repaired only by a qualified technician.



Keep out of children
Failure to observe this precaution could result in injury



WARNING: Failure to follow these instructions could result in fire, electric shock, or other injury or damage.

Table of Contents

IMPORTANT SAFETY INFORMATION	2
TABLE OF CONTENTS	3
OVERVIEW	4
GETTING STARTED	6
QUICK INSTALLATION	10
OPERATIONS	14
FAQ - FREQUENTLY ASKED QUESTIONS	16
WARRANTY AND SERVICE	17
PRODUCT SPECIFICATION WDS-1	18
PRODUCT SPECIFICATION WTP-1	19

WTP-1 Overview

Thank you for choosing a Woo Audio product. The WTP-1 is finely hand-crafted Top-Loading CD Transport that delivers uncompromised performance and superior listening experience.

- ❖ Vibration resistant CD tray construction
- ❖ Customized high damping suspension springs for CD tray
- ❖ ½" (13mm) thick solid aluminum CD tray, CNC milled
- ❖ High precision magnetic disc clamp with short circuit ring and low mechanical inertia
- ❖ High traction CD cover arm
- ❖ VFD monitor
- ❖ Customized ultra-low temperature coefficient Crystal clock
- ❖ Customized toroidal power transformer
- ❖ Individual power supplies for both digital and mechanical circuits
- ❖ Multi-layer military grade PCBs
- ❖ Ultra-low noise, high precision resistors and selected components
- ❖ All-aluminum layered chassis with no screws visible from any viewing angles
- ❖ Allows for track forward/backward, play/pause, stop, fast-forward/backward, track repeat, and play-time in different modes

WDS-1 Overview

Thank you for choosing a Woo Audio product. The WDS-1 is finely hand-crafted Digital to Analog Converter that delivers uncompromised performance and superior listening experience.

- ❖ 24-Bit, 192kHz high resolution playback
- ❖ Ultra-low jitter USB 2.0 runs on Asynchronous mode
- ❖ S/PDIF interfaces through Optical, Coaxial, and AES/EBU through XLR connector
- ❖ Digital volume control allows for direct connection to any power amplifier
- ❖ VFD monitor display
- ❖ Input switching button for all digital inputs
- ❖ Selectable digital filter in Sharp and Slow modes
- ❖ All-aluminum chassis with no screws visible from any viewing angles
- ❖ Individual power supplies for both digital and analog circuitries
- ❖ Multi-layer military grade PCBs
- ❖ Customized driver for Windows XP/Vista/7/8
- ❖ USB Audio Class 2.0 is natively supported by Apple OS X version 10.6.4 and above

Getting Started

What's in the box?

WTP-1

- ① WTP-1 Top-Loading CD Transport
- ② Premium Remote Control
- ③ Magnetic Disc Clamp
- ④ Rubber Transport Plate

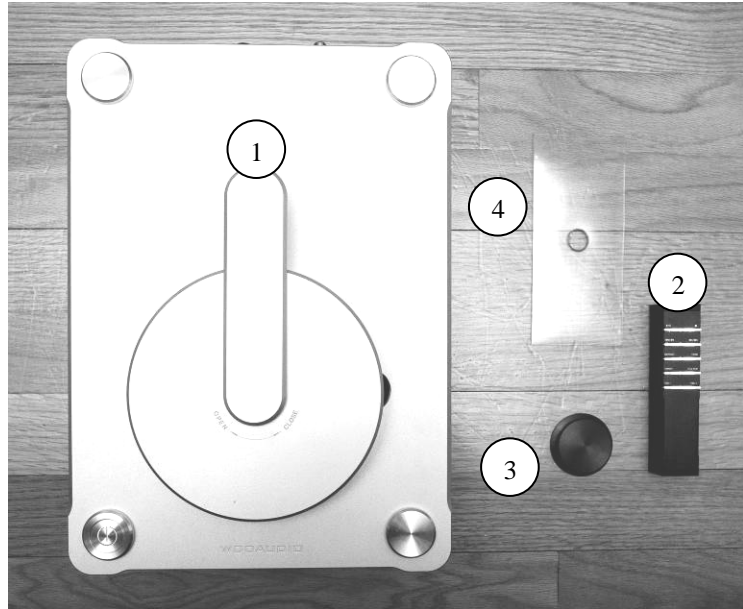

WTP-1

- ① WDS-1 Digital to Analog Converter



- ❖ Power cord and AC Umbilical cord are not included and can be purchased separately.
- ❖ Foot Stands may also be purchased separately to allow for stacking of the 2 units.
- ❖ The Premium Remote Control may be purchased separately to accompany the WDS-1

Back Panel Diagram

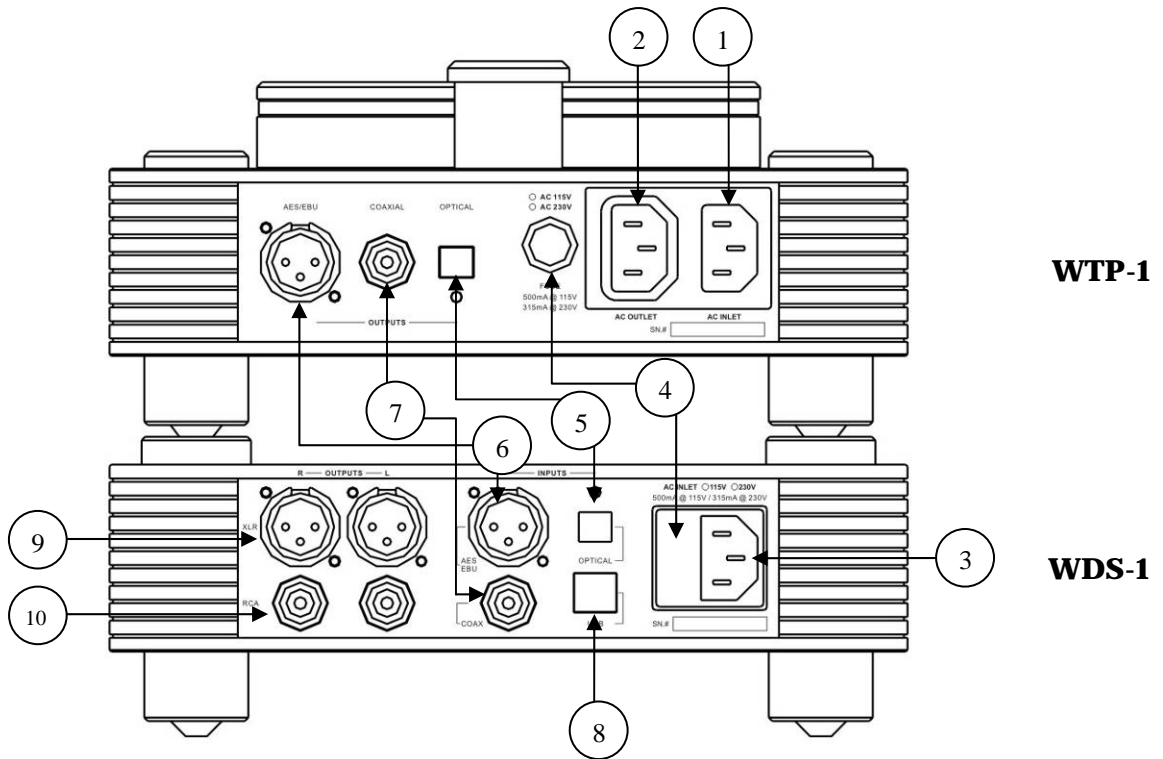

- ① AC Inlet
- ② AC Umbilical Cord Female Outlet
- ③ AC Umbilical Cord Male Inlet
- ④ Fuse Port
- ⑤ Optical Output(Top) and Input(Bottom)
- ⑥ AES/EBU Output(Top) and Input(Bottom)
- ⑦ Coaxial BNC Output(Top) and BNC Input(Bottom)
- ⑧ USB 2.0 Input
- ⑨ XLR Balanced Outputs
- ⑩ RCA Unbalanced Outputs

Front Panel Diagram

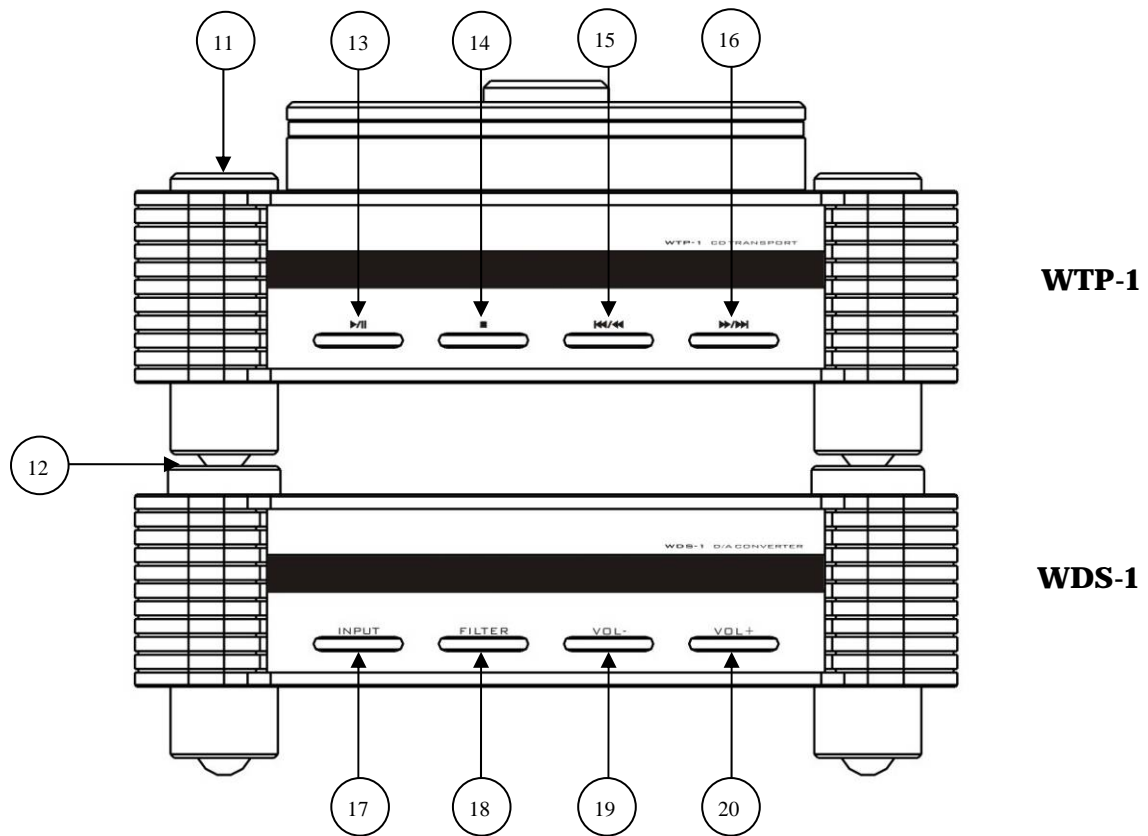

- ① WTP-1 Power Button/Simultaneous Power button when units are stacked
- ② WDS-1 Power Button
- ③ Play/Pause Button
- ④ Stop Button
- ⑤ Rev/Rewind(Hold down) Button
- ⑥ Next/Fast Forward(Hold Down) Button
- ⑦ Input Button
- ⑧ Filter Button
- ⑨ Volume Down
- ⑩ Volume Up

Premium Remote Control

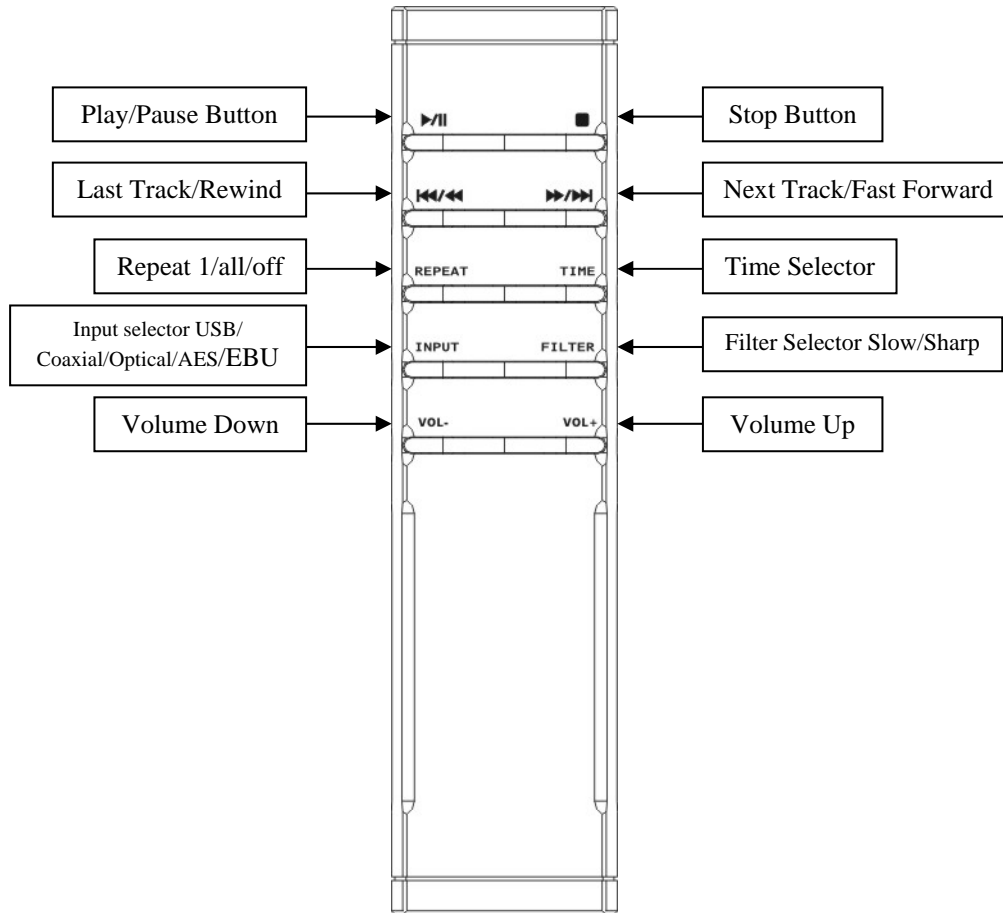

- ❖ The Premium Remote Control is included standard with the WTP-1 and can be purchased separately for the WDS-1
- ❖ Premium Remote Control has a range of 10 feet working at angles up to 30 degrees

Quick Installation

Installing the power cord:

Plug the power cord into the AC inlet; see ① in the above diagram. The AC inlet socket is a standard IEC type. You will need to obtain the correct type for your region.



U.S.



European



U.K.

Take the AC umbilical cord and plug it into AC Female Outlet ② of the WTP-1 and AC Male Inlet of WDS-1 ③. Refer to the above diagram.

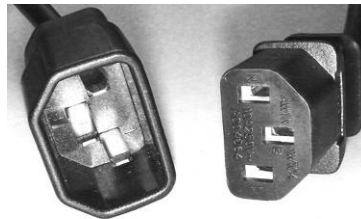

* If you are intending to use the AC umbilical cord to stack the two units, attach and power up the two units first side by side before stacking the units together. This is to make sure that both the WTP-1 and WDS-1 are powered up.

Stacking:

The WTP-1 and WDS-1 are capable of stacking together when the optional foot stands are purchased.



Powering Up

To power up on the WTP-1 press the power button⑪ until pressure is felt and the VFD screen should turn on.

To power up on the WDS-1 press the power button⑫ until pressure is felt and the VFD screen should turn on.

If you buy both WTP-1 and WDS-1 and decide to stack them. The power button on the WTP-1 ⑪ becomes a simultaneous power button and will be able to power up both WTP-1 and WDS-1 at the same time. Refer to **Installing the Power Cord** on how to do this.

Connecting the WTP-1 with the WDS-1:

Here at Woo Audio we believe flexibility is extremely important, which is why we offer three ways to pair the WTP-1 and WDS-1 together; Optical ⑤, AES/EBU ⑥, Coaxial ⑦ refer to the above diagram.*

*These three connections allow for 16-Bit/44.1kHz CD quality of music for your listening pleasure.

Using the Asynchronous USB 2.0 port:

The WDS-1 offers a fourth source of music input, a USB 2.0 port ⑧ refer to the above diagram, which allows for usage of the WDS-1 DAC with Windows or Mac OS computer.

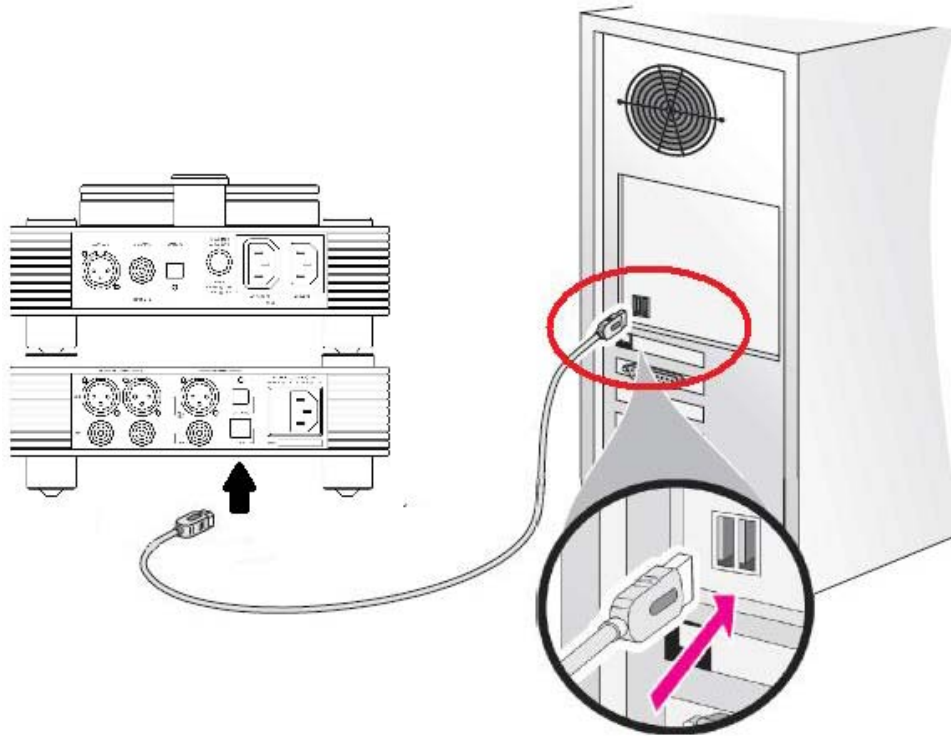

Installing the USB driver

*These steps only apply for Windows XP/Vista/7/8.

1. Plug in the USB 2.0 cable to the WA7 Fireflies and your computer.
2. Install the WA7 Fireflies Driver from the downloaded file from <https://www.dropbox.com/s/2c8n0d01c2b1c10/wds1-driver-1.01.zip>
3. Unzip the downloaded file. Locate setup.exe file and run it.
4. Follow on-screen instruction to complete the installation. Windows restart may be required.
5. Set USB Speakers as your default audio output.

Go to My Computer -> Control Panel -> Hardware and Sounds -> Sounds
-> Click SPDIF Speakers -> Click Set Default

6. Now you're ready to enjoy music from your computer.

Configuring media player

TIPS: It is strongly recommended to use a media player that supports ASIO output mode for the highest playback quality.

Changing Output mode

Example is given for JRiver Media Center.

Tools -> Options -> Audio Output -> Output mode -> select ASIO

IMPORTANT: In JRiver Media Center, disable “Use large hardware buffers” option by unchecking the box. Buffering error will occur if this option is enable.

Tools -> Options -> Audio Output -> Output mode settings -> uncheck the box below

Use large hardware buffers (recommended to prevent stutter)

NOTE: Increasing buffering makes playback less likely to skip and hiccup, but also increases the time it takes for cross-fades and smooth-seeks to kick in.

Connecting the Amp to the WDS-1:

The WDS-1 offers two sources of output, XLR ⑨ and RCA ⑩ refer to the above diagram to connect the amp of your choice. We highly recommend one of our Woo Audio Amplifiers.

Operations

Using the WTP-1 CD Transport:



Before you begin using your WTP-1 make sure you remove the rubber transport plate from the CD tray.

Opening of the CD tray on the WTP-1 is done by sliding the cover horizontally until it rotates to the left and the CD tray is revealed. Refer to the picture.

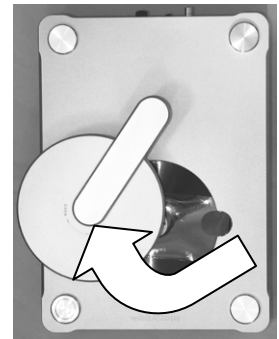

*Remember to replace the magnetic disc clamp onto the CD tray after putting in the CD.

Buttons

▶/||: Plays music or Pauses the track if already on playback

■: Stops music, resets back to the beginning of the track

◀◀/◀: Goes back one track or if held will rewind the track

▶▶/▶: Goes forward one track or if held will fast forward the track

Using the WDS-1 Digital to Analog Converter:

Now that we have everything properly connected and setup we can begin to enjoy the music.

Buttons

Input: Allow for the selection of input device.

- Coaxial -> Optical -> AES/EBU -> USB

Filter: Choose one of two of our filter settings

- Slow -> Sharp

Vol -: Lowers Volume

- Maximum->Minimum (100->0)

Vol +: Increases Volume

- Minimum->Maximum (0->100)

Remember to choose the proper input of music source and set the volume to your preference.

FAQ - Frequently Asked Questions

When the Simultaneous power button is pressed, only the WTP-1 turned on but not the WDS-1.

- To protect the circuitry of the WDS-1 there is a 10 second delay in between power ups.
- Make sure the WDS-1 power button is in the on position before connecting the AC umbilical cord and using the simultaneous power button.

No sound is coming out of the WDS.

- Check you have selected the correct input.

Pressed the play button on the CD transport but nothing plays.

- Make sure the rubber transport plate is removed from the CD tray before putting on the CD.
- Make sure the magnetic disc clamp is placed on the CD.

I want to change my unit from 110v to 220v but I can't seem to find the switch.

- The WTP-1 and WDS-1 units are not customer switchable but instead can be factory configured before you order or you can send it in and we can change it for you.

The VFD screen does not light.

First check if the AC cord is installed. Then, check if the fuse is burnt. See the following instruction on how to replace a fuse. The fuse type is 2-3A, slo-blow.



Insert a small flat screwdriver into the fuse door which located on the AC inlet.



Release the fuse door by pulling it out.



The fuse holder is released from the AC inlet.



The fuse is held by a clip.

Warranty and Service

Woo Audio warrants this product free from defects in materials and workmanship for 1 year from the original date of purchase. The tubes are warranted for 30 days unless otherwise stated. In the event that your Woo Audio product requires servicing, please contact us directly to get a return instruction. If the equipment needs to be shipped back, please use the original packaging and include a copy of the sales purchase along with detail explanation of the problem(s).

Send service inquiry to woaudio@gmail.com

Any modification not authorized by WOO AUDIO will void this warranty.

Product Specification

Model:	WDS-1
Chipset:	PCM1795 D/A
USB receiving chipset:	C-Media 6631A
Sampling Rate:	Up to 24-Bit, 192kHz for all inputs
Inputs:	Asynchronous USB 2.0, Optical, AES/EBU, Coaxial BNC
Outputs:	1 RCA unbalanced, 1 XLR balanced
Max Output:	2.2vRMS@RCA, 4.4vRMS@XLR
Frequency response:	10Hz to 20kHz, +/- 0.5dB
Distortion:	<0.002%
S/N:	120dB
Remote Control:	Optional
Mains Supply:	100-120v, 220-240v, 50/60Hz, factory configurable
Finish :	Anodized Aluminum
Dimension:	84mm (H) x 230mm (W) x 320mm (D)
Weight:	9 lbs / 4 kg

Product Specification

Model:	WTP-1
Optical pick up	Philips
Outputs:	1 Coaxial BNC, 1 Optical, 1 AES/EBU
Output Voltage:	500mV p-p
Crystal Oscillator Stability:	0.3ppm/°C TCXO
Clock Jitter:	<90pS
Remote Control:	All-aluminum premium remote control
Power Consumption:	<10VA
Voltage:	AC 110-120v/220 - 240V, 50/60 Hz, factory configurable
Finish	Anodized Aluminum
External Dimension, end to end measurement, same for both units:	84mm (H) x 230mm (W) x 320mm (D)
Weight (AMP & PSU):	10 lbs / 4.5 kg

Woo Audio is committed to continuously improve its products. We reserve the right to improve the design without notice.