**HEADPHONE STAND
HPS-R SINGLE, HPS-T DOUBLE
ADJUSTABLE HEIGHT**



INSTALLATION GUIDE

HPS-T Double installation is not shown. The procedure is identical to this document.

What's in the box?



- ① Wing nut screw
- ② Base barrel
- ③ Shaft screw
- ④ Base
- ⑤ Headband holder
- ⑥ Base feet
- ⑦ Headband holder shaft

- ❖ Adjustable height: from 11" to 14"
- ❖ Full aluminum, solid and stable
- ❖ 3/4" thick base
- ❖ Base diameter: 6-1/3"
- ❖ Fast to assemble and disassemble
- ❖ Easy to adjust height
- ❖ Weight: 4 pounds for single (R), 5 pounds for double (T)

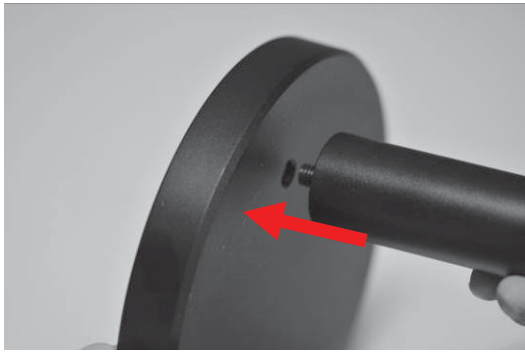

1

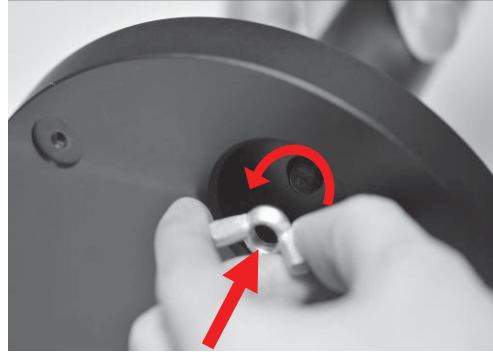

2

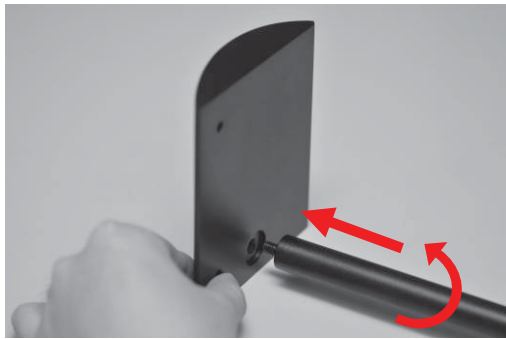

3

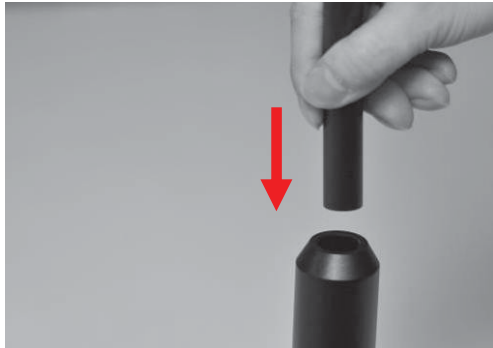

4



5



6